

SAMSUNG END CAPS (A GENERAL TIP ON ALMOST ALL CORES)

By Mike Josiah and the Technical Staff at UniNet

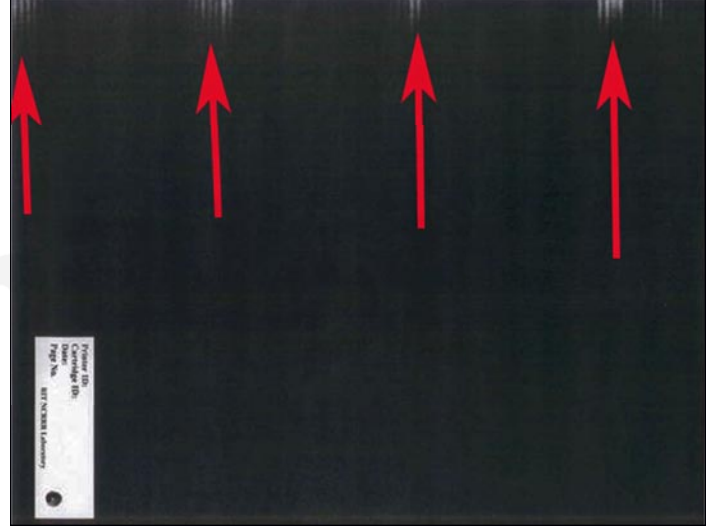
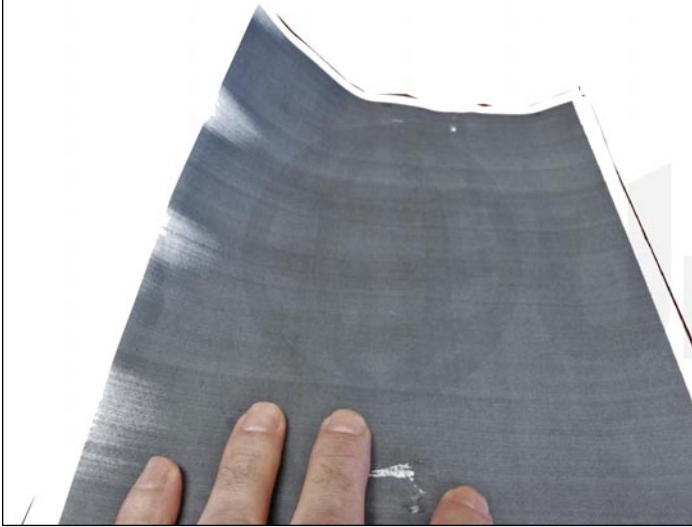

Most Samsung cartridge end caps these days are held in place with plastic rivets. These rivets (melted plastic posts) need to have the heads cut off and small holes drilled so that screws can be installed.

We have seen quite a few examples of problems with this process - not all the posts were drilled and screwed in place, screws were installed in the wrong place, or screws were not fully seated allowing the end caps to move. All these issues can cause banding.



TWO EXAMPLES OF WHAT NOT TO DO

A Dremel type tool was used to cut the rivets off and drill the holes for the screws (a flat chisel X-ACTO type knife works best). The holes for the screws are now too large and the screws will not hold the end caps on properly. We have found that using a #29 drill bit and a #8 x 1/4" self-tapping screw works best.

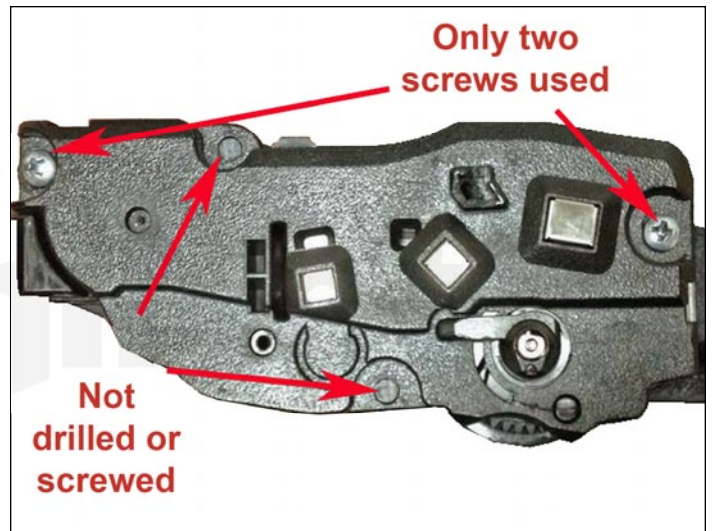
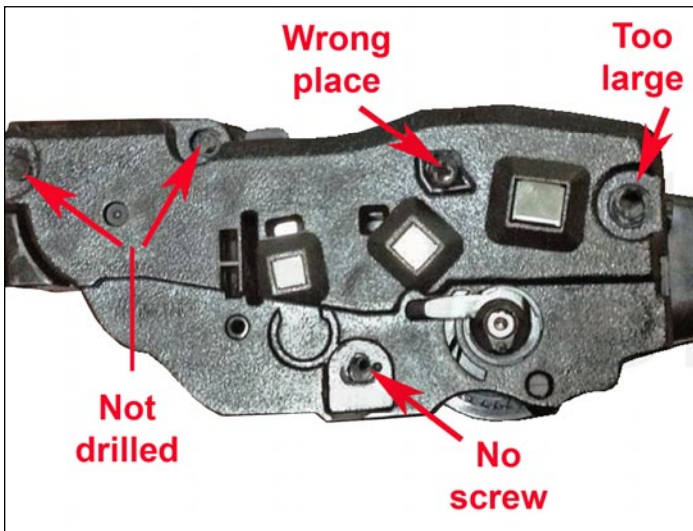

Shown are a few problems: posts were not drilled and screwed; only two screws were used instead of four; an extra screw was installed in the wrong place; and one of the holes (not screwed) is too large for a screw to hold that point in place properly.

Being careful in the initial setup of these cartridges will ensure even printing with no voids or banding and will also ensure you get the maximum life from your cores.